

Roof Report

Prepared by Roofr

7450 West Mohawk Lane, Glendale, AZ 85308

2643 sqft

6 facets

Predominant pitch 5/12



Diagram

7450 West Mohawk Lane, Glendale, AZ 85308

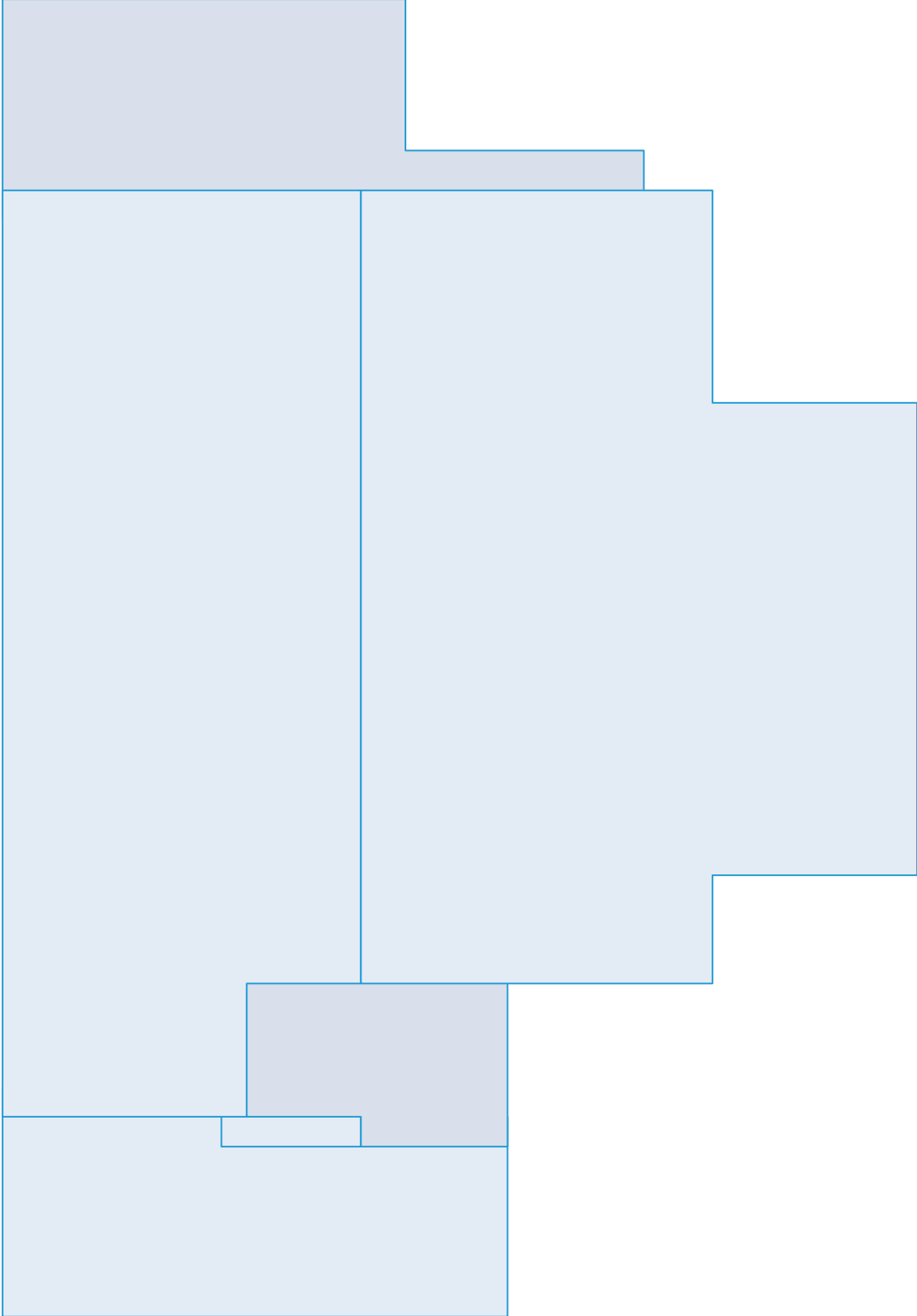

Length measurement report

7450 West Mohawk Lane, Glendale, AZ 85308

- Eaves: 157ft 3in
- Valleys: 0ft 0in
- Hips: 0ft 0in
- Ridges: 51ft 1in
- Rakes: 168ft 4in
- Wall flashing: 57ft 11in
- Step flashing: 23ft 6in
- Transitions: 0ft 0in
- Parapet wall: 0ft 0in
- Unspecified: 8ft 3in

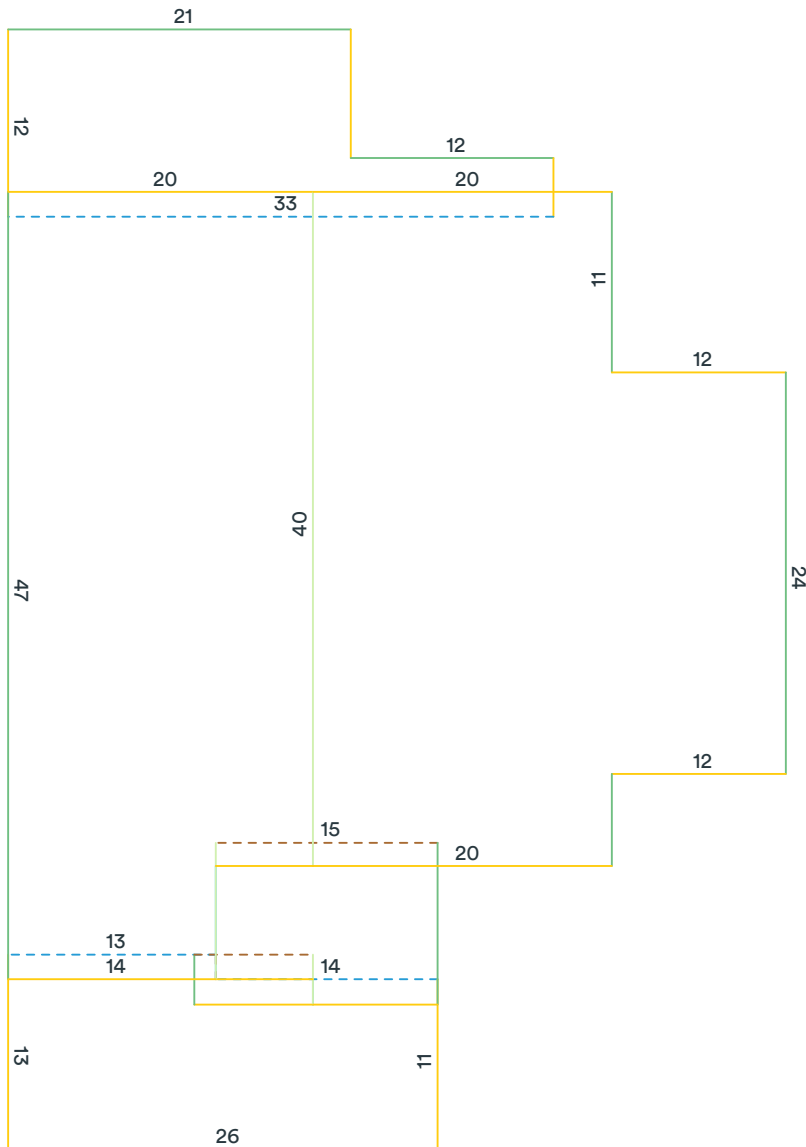

Measurements in diagram are rounded up for display. Some edge lengths may be hidden from diagram to avoid overcrowding.

Area measurement report

7450 West Mohawk Lane, Glendale, AZ 85308

Total roof area: 2643 sqft

Pitched roof area: 2643 sqft

Flat roof area: 0 sqft

Two story area: 0 sqft

Two layer area: 0 sqft

Predominant pitch: 5/12

Predominant pitch area: 2366 sqft

Unspecified pitch area: 0 sqft

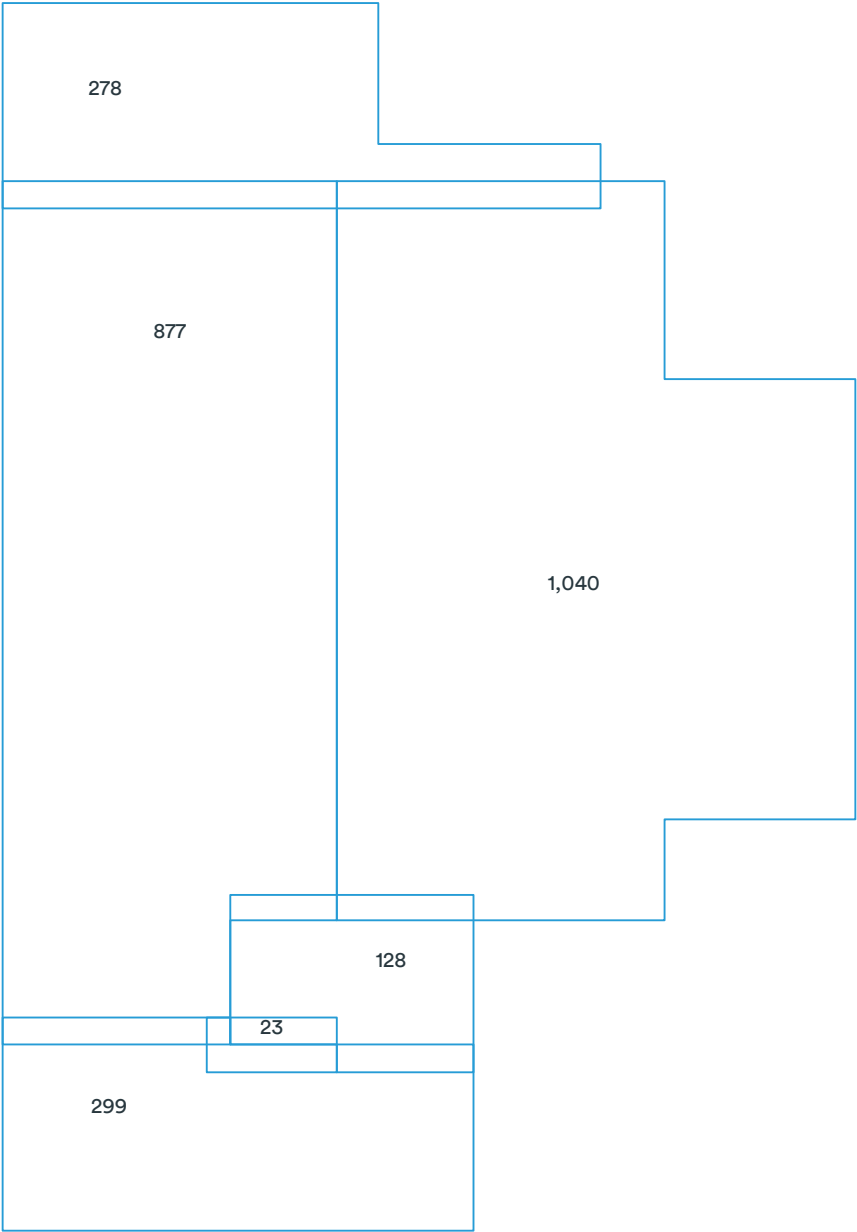

Area measurements in diagram are rounded. The totals at the top of the page are the sums of the exact measurements, which are then rounded. Deleted facets (skylights, chimneys, etc.) are designated with a dashed line and are excluded from the calculations.

Pitch & direction measurement report

7450 West Mohawk Lane, Glendale, AZ 85308

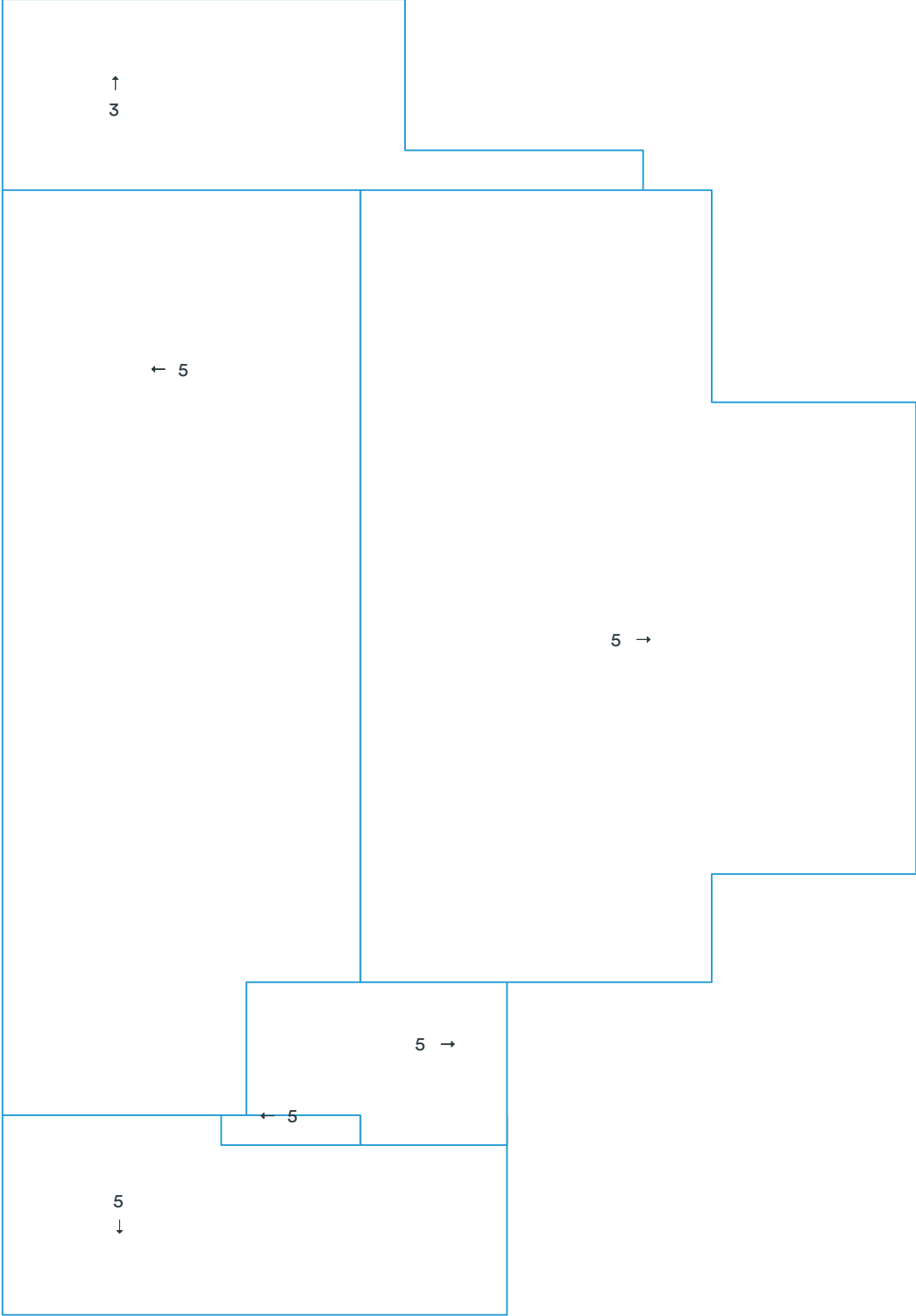

Deleted facets are designated with a dashed line and do not have a pitch.

Report summary

7450 West Mohawk Lane, Glendale, AZ 85308

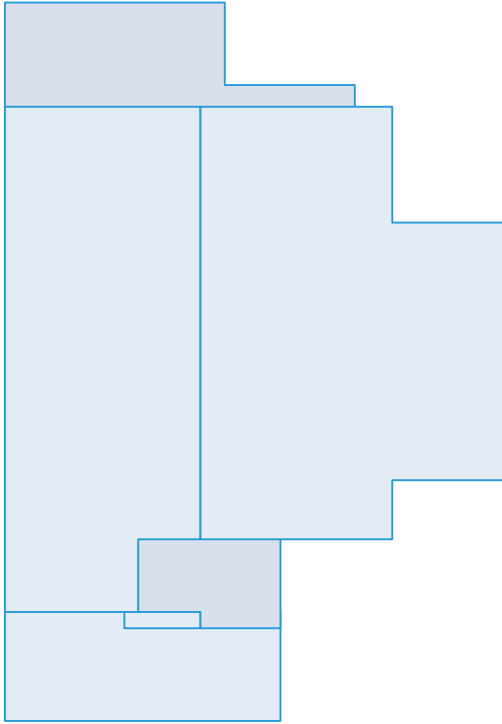

Measurements

Total roof area	2643 sqft
Total pitched area	2643 sqft
Total flat area	0 sqft
Total roof facets	6 facets
Predominant pitch	5/12
Total eaves	157ft 3in
Total valleys	0ft 0in
Total hips	0ft 0in
Total ridges	51ft 1in
Total rakes	168ft 4in
Total wall flashing	57ft 11in
Total step flashing	23ft 6in
Total transitions	0ft 0in
Total parapet wall	0ft 0in
Total unspecified	8ft 3in
Hips + ridges	51ft 1in
Eaves + rakes	325ft 7in

Pitch	3/12	5/12
Area (sqft)	278	2,366
Squares	2.8	23.7

Recommended

Waste %	0%	9%	10%	12%	15%	17%	20%
Area (sqft)	2,643	2,881	2,907	2,960	3,040	3,092	3,172
Squares	26.5	28.9	29.1	29.6	30.4	31.0	31.8

Recommended waste is based on an asphalt shingle roof with a closed valley system (if applicable). Several other factors are involved in determining which waste percentage to use, including the complexity of the roof and individual roof application style. You will also need to calculate the post-waste quantity of other materials needed (hip and ridge caps, starter shingle, etc.).

This report was prepared by Roofr. Copyright © 2024 Roofr.com | All rights reserved.

Material calculations

7450 West Mohawk Lane, Glendale, AZ 85308

Product	Unit	Waste (0%)	Waste (9%)	Waste (10%)	Waste (15%)
Shingle (total sqft)		2,643 sqft	2,881 sqft	2,907 sqft	3,040 sqft
IKO - Cambridge	bundle	80	87	88	92
CertainTeed - Landmark	bundle	81	88	89	93
GAF - Timberline	bundle	81	88	89	93
Owens Corning - Duration	bundle	81	88	89	93
Atlas - Pristine	bundle	81	88	89	93
Starter (eaves + rakes)		326 ft	355 ft	359 ft	375 ft
IKO - Leading Edge Plus	bundle	3	4	4	4
CertainTeed - SwiftStart	bundle	3	4	4	4
GAF - Pro-Start	bundle	3	3	3	4
Owens Corning - Starter Strip	bundle	4	4	4	4
Atlas - Pro-Cut	bundle	3	3	3	3
Ice and Water (eaves + valleys + flashings)		239 ft	261 ft	263 ft	275 ft
IKO - StormShield	roll	4	5	5	5
CertainTeed - WinterGuard	roll	4	5	5	5
GAF - WeatherWatch	roll	4	4	4	5
Owens Corning - WeatherLock	roll	4	4	4	4
Atlas - Weathermaster	roll	4	5	5	5
Synthetic (total sqft; no laps)		2,643 sqft	2,881 sqft	2,907 sqft	3,040 sqft
IKO - Stormtite	roll	3	3	3	4
CertainTeed - RoofRunner	roll	3	3	3	4
GAF - Deck-Armor	roll	3	3	3	4
Owens Corning - RhinoRoof	roll	3	3	3	4
Atlas - Summit	roll	3	3	3	4
Capping (hips + ridges)		52 ft	56 ft	57 ft	59 ft
IKO - Hip and Ridge	bundle	2	2	2	2
CertainTeed - Shadow Ridge	bundle	2	2	2	2
GAF - Seal-A-Ridge	bundle	3	3	3	3
Owens Corning - DecoRidge	bundle	3	3	3	3
Atlas - Pro-Cut H&R	bundle	2	2	2	2
Other					
8' Valley (no laps)	sheet	0	0	0	0
10' Drip Edge (eaves + rakes; no laps)	sheet	33	36	36	38

These calculations are estimates and are not guaranteed. Always double check calculations before ordering materials. Estimates are based off of the total pitched area (i.e., flat area is excluded).