



Roof Report

Prepared by Roofr

6701 East Fanfol Drive, Paradise Valley, AZ 85253

11111 sqft

6 facets

Predominant pitch 0/12



Nearmap Jan 30, 2025





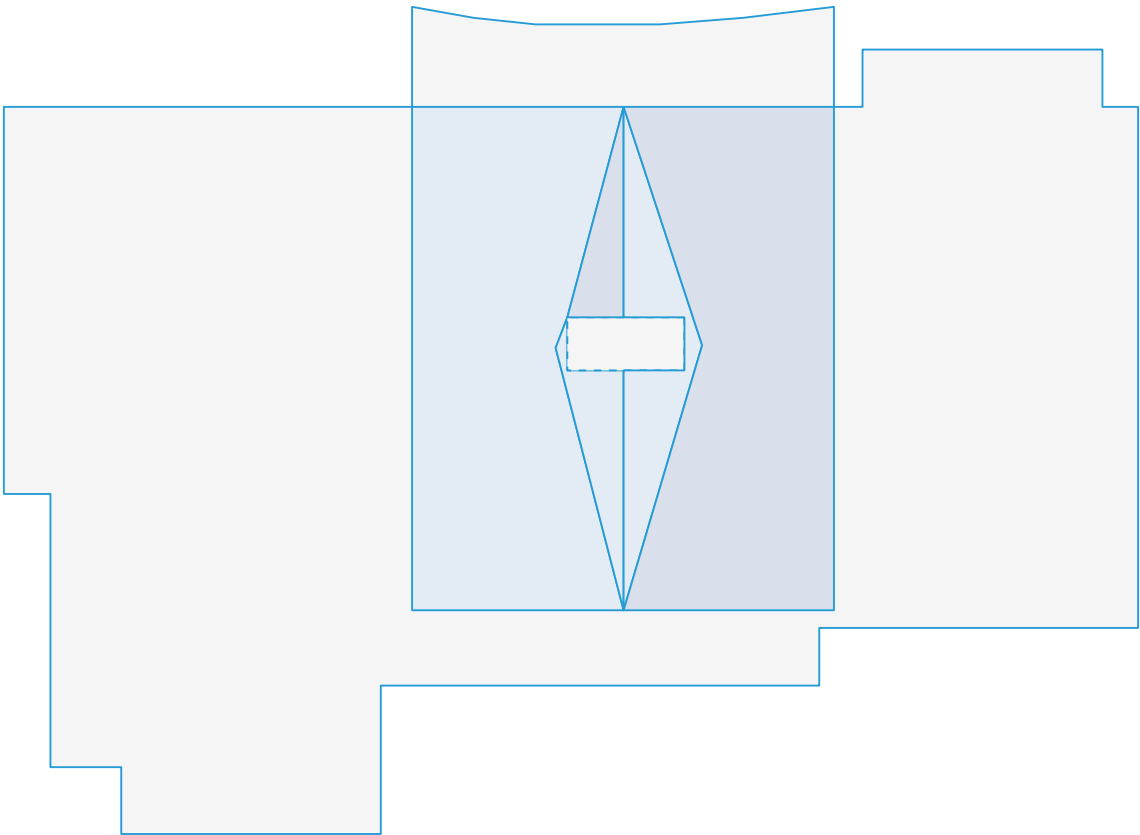





Diagram

6701 East Fanfol Drive, Paradise Valley, AZ 85253



Length measurement report

6701 East Fanfol Drive, Paradise Valley, AZ 85253

- | | | |
|--|--|--|
|  Eaves: 494ft 5in |  Valleys: 128ft 5in |  Hips: 0ft 0in |
|  Ridges: 178ft 4in |  Rakes: 103ft 7in |  Wall flashing: 227ft 10in |
|  Step flashing: 28ft 9in |  Transitions: 0ft 0in |  Parapet wall: 0ft 0in |
|  Unspecified: 0ft 0in | | |

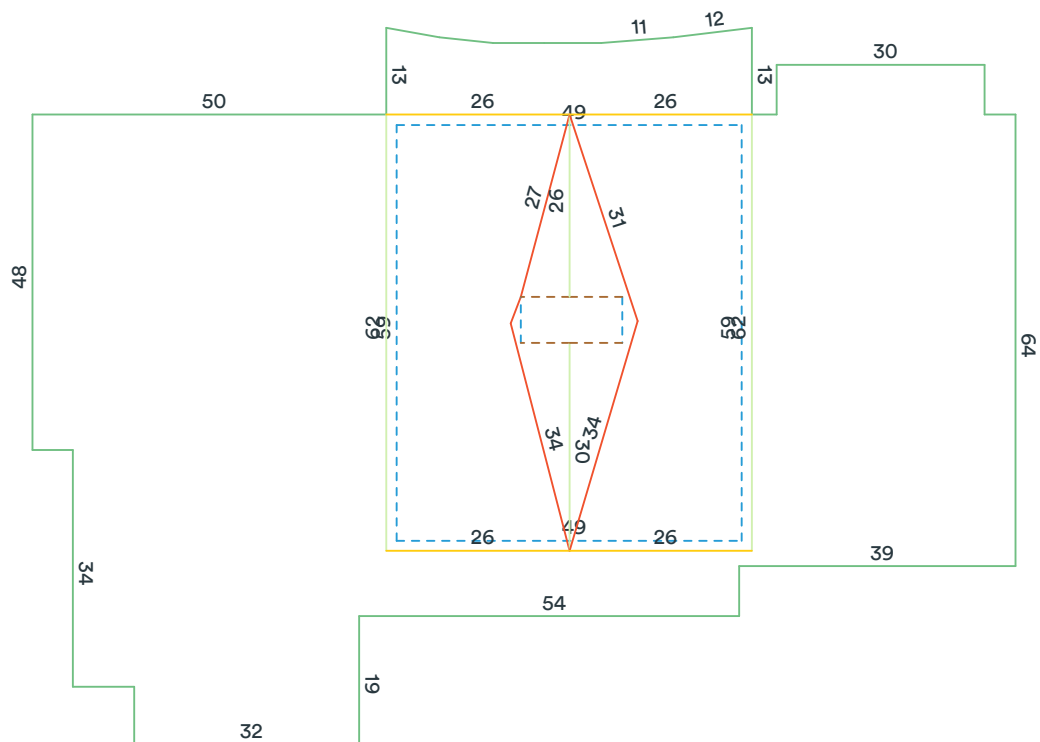

Measurements in diagram are rounded up for display. Some edge lengths may be hidden from diagram to avoid overcrowding.

Area measurement report

6701 East Fanfol Drive, Paradise Valley, AZ 85253

Total roof area: 11111 sqft

Pitched roof area: 0 sqft

Flat roof area: 11111 sqft

Two story area: 0 sqft

Two layer area: 0 sqft

Predominant pitch: 0/12

Predominant pitch area: 8006 sqft

Unspecified pitch area: 0 sqft

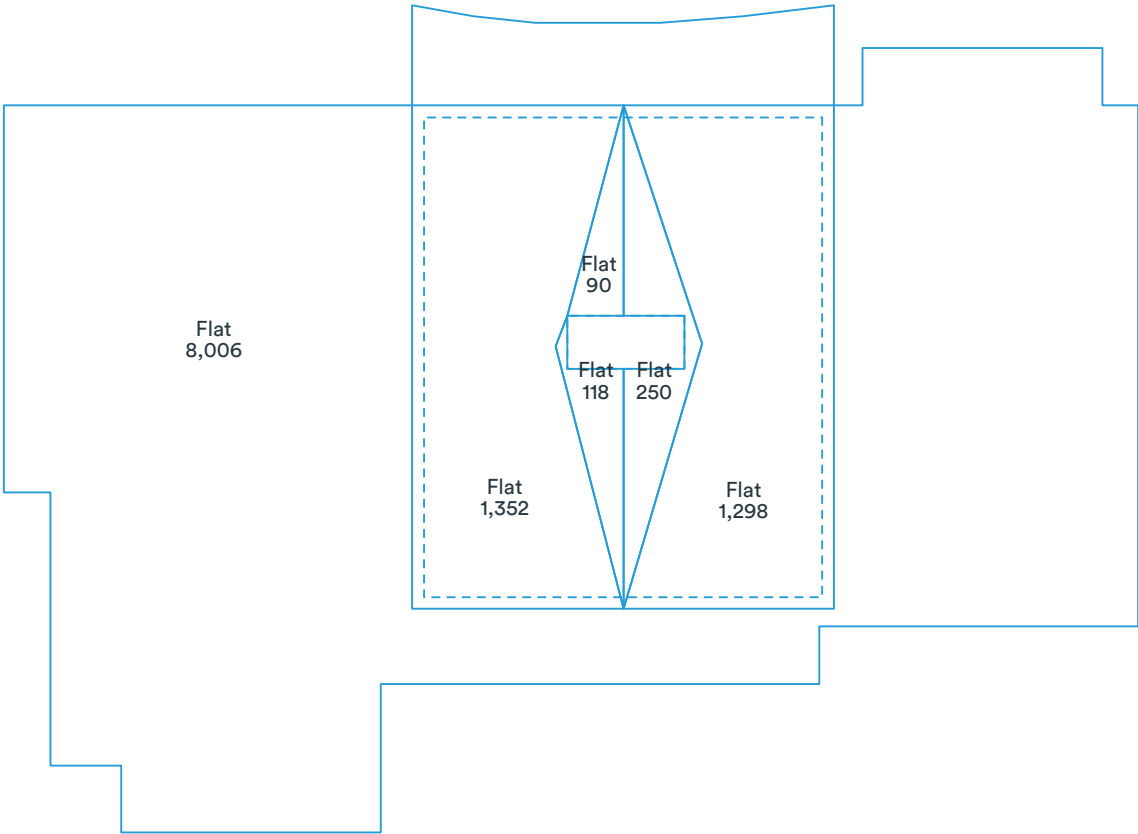

Area measurements in diagram are rounded. The totals at the top of the page are the sums of the exact measurements, which are then rounded. Deleted facets (skylights, chimneys, etc.) are designated with a dashed line and are excluded from the calculations.

Pitch & direction measurement report

6701 East Fanfol Drive, Paradise Valley, AZ 85253

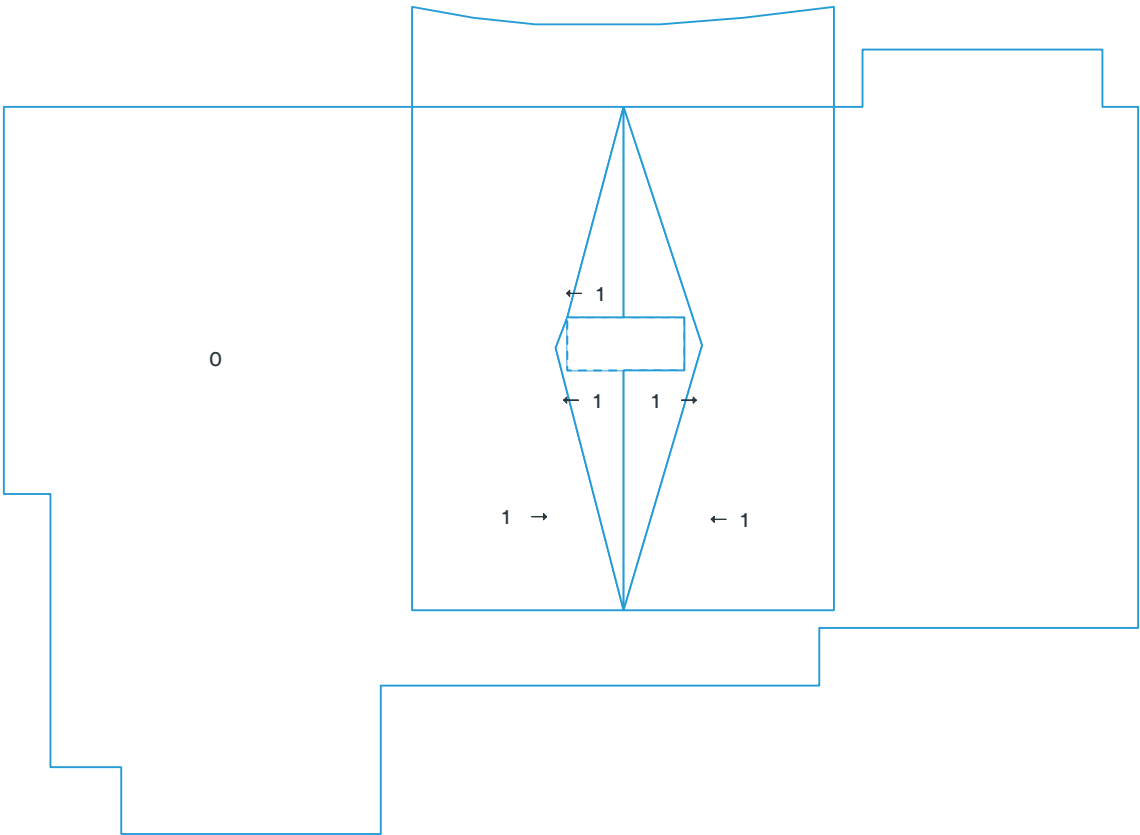

Deleted facets are designated with a dashed line and do not have a pitch.

Report summary

6701 East Fanfol Drive, Paradise Valley, AZ 85253

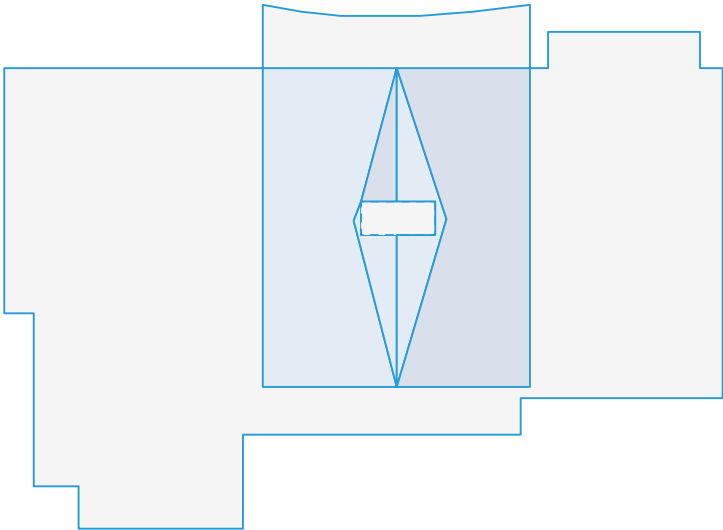

Measurements

Total roof area	11111 sqft
Total pitched area	0 sqft
Total flat area	11111 sqft
Total roof facets	6 facets
Predominant pitch	0/12
Total eaves	494ft 5in
Total valleys	128ft 5in
Total hips	0ft 0in
Total ridges	178ft 4in
Total rakes	103ft 7in
Total wall flashing	227ft 10in
Total step flashing	28ft 9in
Total transitions	0ft 0in
Total parapet wall	0ft 0in
Total unspecified	0ft 0in
Hips + ridges	178ft 4in
Eaves + rakes	598ft 0in

Pitch	0/12	1/12
Area (sqft)	8,006	3,106
Squares	80.1	31.1

Recommended

Waste %	0%	4%	10%	12%	15%	17%	20%
Area (sqft)	11,111	11,556	12,222	12,445	12,778	13,000	13,334
Squares	111.2	115.6	122.3	124.5	127.8	130.0	133.4

Recommended waste is based on an asphalt shingle roof with a closed valley system (if applicable). Several other factors are involved in determining which waste percentage to use, including the complexity of the roof and individual roof application style. You will also need to calculate the post-waste quantity of other materials needed (hip and ridge caps, starter shingle, etc.).
This report was prepared by Roofr. Copyright © 2025 Roofr.com | All rights reserved.

Material calculations

6701 East Fanfol Drive, Paradise Valley, AZ 85253

Product	Unit	Waste (0%)	Waste (4%)	Waste (10%)	Waste (15%)
Shingle (total sqft)					
IKO - Cambridge	bundle	0	0	0	0
CertainTeed - Landmark	bundle	0	0	0	0
GAF - Timberline	bundle	0	0	0	0
Owens Corning - Duration	bundle	0	0	0	0
Atlas - Pristine	bundle	0	0	0	0
Starter (eaves + rakes)		599 ft	622 ft	658 ft	688 ft
IKO - Leading Edge Plus	bundle	6	6	6	6
CertainTeed - SwiftStart	bundle	6	6	6	6
GAF - Pro-Start	bundle	5	6	6	6
Owens Corning - Starter Strip	bundle	6	6	7	7
Atlas - Pro-Cut	bundle	5	5	5	5
Ice and Water (eaves + valleys + flashings)		880 ft	915 ft	968 ft	1,012 ft
IKO - StormShield	roll	14	15	15	16
CertainTeed - WinterGuard	roll	14	15	15	16
GAF - WeatherWatch	roll	14	14	15	16
Owens Corning - WeatherLock	roll	12	13	13	14
Atlas - Weathermaster	roll	14	15	15	16
Synthetic (total sqft; no laps)					
IKO - Stormtite	roll	0	0	0	0
CertainTeed - RoofRunner	roll	0	0	0	0
GAF - Deck-Armor	roll	0	0	0	0
Owens Corning - RhinoRoof	roll	0	0	0	0
Atlas - Summit	roll	0	0	0	0
Capping (hips + ridges)		179 ft	186 ft	197 ft	206 ft
IKO - Hip and Ridge	bundle	5	5	5	6
CertainTeed - Shadow Ridge	bundle	6	7	7	7
GAF - Seal-A-Ridge	bundle	8	8	8	9
Owens Corning - DecoRidge	bundle	9	10	10	11
Atlas - Pro-Cut H&R	bundle	6	6	7	7
Other					
8' Valley (no laps)	sheet	17	17	18	19
10' Drip Edge (eaves + rakes; no laps)	sheet	60	63	66	69

These calculations are estimates and are not guaranteed. Always double check calculations before ordering materials. Estimates are based off of the total pitched area (i.e., flat area is excluded).